

### Ampak® aluminium anodes

Cathodic protection with high-quality aluminium anodes for salt water and brackish water



#### Advantages:

- + Tested according to D.N.V. RP-B-401
- + Very economical corrosion protection due to high electrical capacity
- + Reduced weight and more environmentally friendly compared to traditional zinc anodes
- + Corresponds to NORSOK Standard M-503 specification

#### Applications:

- + Corrosion protection in salt water and brackish water
- + Anodes available as welded or bolt-on types
- + Hull anodes and ballast tank anodes available
- + From standard to customized anodes

Ampak® is the worldwide known brand for cathodic corrosion protection. It is synonymous with high-quality anodes and Ampak's complete and long-term expertise in the field of design, production and application of corrosion prevention systems. Our company cooperates closely together with major ship-owners, the maritime and offshore (wind) industry, port authorities and maritime design companies.

Depending on the environment, the size and type of construction and finally the time until the next scheduled maintenance, Ampak® offers different cathodic protection systems. As a general rule we recommend selecting the anodes as those being suitable for the water the vessel regularly operates in.

Salt water	Brackish water	Fresh water
Zinc anodes or aluminium anodes	Aluminium anodes	Magnesium anodes

## ALUMINIUM HULL ANODES

Pear-shape

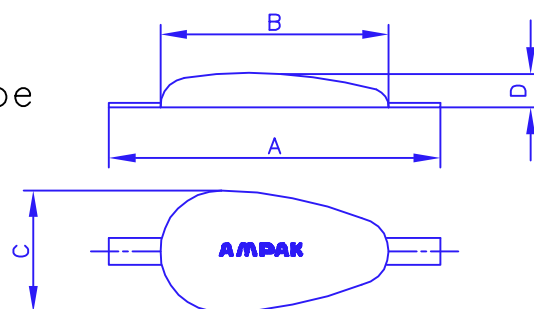

TYPE	A	B	C	D	welding strip	weight	
						net	gross
2,5-Al	180	110	60	27	20x3	0,25 kg	0,3 kg
4-Al	180	120	80	23	25x3	0,4 kg	0,5 kg
4-Al-H	250	160	66	26	25x5	0,4 kg	0,6 kg
6-Al	180	120	80	34	25x3	0,6 kg	0,7 kg
8-Al	245	170	100	32	25x3	0,8 kg	1,0 kg
10-Al	300	240	80	38	20x3	1,0 kg	1,2 kg
11-Al	245	170	100	40	25x3	1,1 kg	1,3 kg
28-Al	430	300	160	35	30x4	2,8 kg	3,2 kg
37-Al	430	300	160	45	30x4	3,7 kg	4,1 kg

Rectangular-shape

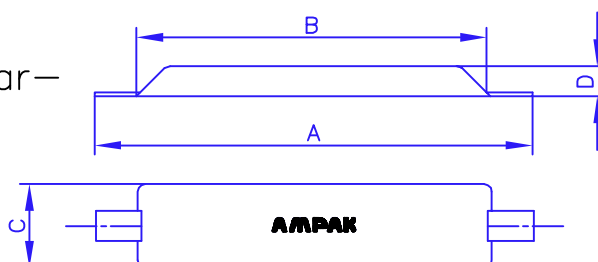

TYPE	A	B	C	D	welding strip	weight	
						net	gross
1,67-Al	140	95	30	13,5	15x3	0,167 kg	0,2 kg
8-Al-H	270	170	80	30	30x4	0,8 kg	1,1 kg
15-Al-H	300	200	105	35	30x4	1,5 kg	1,8 kg
17-Al	430	300	90	35	30x4	1,7 kg	2,1 kg
20-Al	430	300	90	40	30x4	2,0 kg	2,4 kg
23-Al-H	330	235	160	35	40x5	2,3 kg	2,8 kg
37-Al-H	450	350	150	37	40x5	3,7 kg	4,1 kg
45-Al	575	465	110	40	40x5	4,5 kg	5,0 kg
62-Al	630	520	120	40	40x5	6,2 kg	6,8 kg
64-Al-H	550	425	165	40	40x5	6,4 kg	7,2 kg
87-Al	780	680	128	40	40x5	8,7 kg	9,3 kg
105-Al	910	800	120	40	40x5	10,5 kg	11,2 kg
130-Al	1140	1000	120	45	40x5	13,0 kg	14,0 kg
190-Al	1140	1000	120	60	40x5	19,0 kg	20,0 kg
250-Al	1100	1000	120	80	40x5	25,0 kg	26,3 kg