

Ampak® zinc anodes

Cathodic protection with high-quality zinc anodes for salt water



Advantages:

- + Corresponds to US MIL Spec. A-1800 1K
- + Remains electro-chemically active in salt water
- + Uniform corrosion pattern, reliable electrical capacity with long life
- + Different alloy specifications casted to customer needs

Applications:

- + Corrosion protection in salt water
- + Available as welded or bolt-on types
- + Hull anodes and ballast tank anodes available
- + From standard to customized anodes

Ampak® is the worldwide known brand for cathodic corrosion protection. It is synonymous with high-quality anodes and Ampak's complete and long-term expertise in the field of design, production and application of corrosion prevention systems. Our company cooperates closely together with major ship-owners, the maritime and offshore (wind) industry, port authorities and maritime design companies.

Depending on the environment, the size and type of construction and finally the time until the next scheduled maintenance, Ampak® offers different cathodic protection systems. As a general rule we recommend selecting the anodes as those being suitable for the water the vessel regularly operates in.

Salt water	Brackish water	Fresh water
Zinc anodes or aluminium anodes	Aluminium anodes	Magnesium anodes

ZINC HULL ANODES

Pear-shape

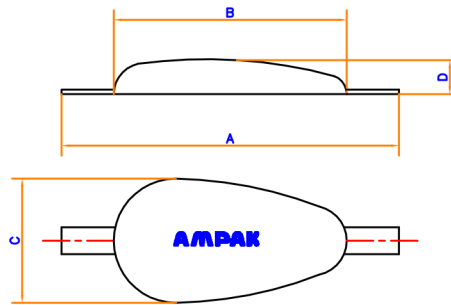

TYPE	A	B	C	D	welding strip	weight	
						net	gross
6-Z	180	110	60	27	20x3	0,6 kg	0,7 kg
9-Z	180	120	80	23	25x3	0,9 kg	1,0 kg
10-Z-H	250	160	66	26	25x5	1,0 kg	1,2 kg
15-Z	180	120	80	34	25x3	1,5 kg	1,6 kg
20-Z	245	170	100	32	25x3	2,0 kg	2,2 kg
26-Z	300	240	80	38	20x3	2,6 kg	2,8 kg
28-Z	245	170	100	40	25x3	2,8 kg	3,0 kg
71-Z	430	300	160	35	30x4	7,1 kg	7,5 kg
96-Z	430	300	160	45	30x4	9,6 kg	10,0 kg

Rectangular-shape

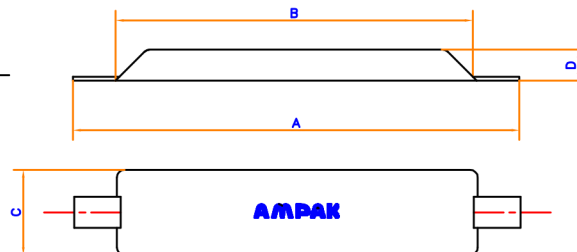

TYPE	A	B	C	D	welding strip	weight	
						net	gross
2,5-Z	140	95	30	13,5	15x3	0,25 kg	0,3 kg
20-Z-H	270	170	80	30	30x4	2,0 kg	2,3 kg
40-Z-H	300	200	105	35	30x4	4,0 kg	4,3 kg
45-Z	430	300	90	35	30x4	4,5 kg	4,9 kg
50-Z	430	300	90	40	30x4	5,0 kg	5,4 kg
60-Z-H	330	235	160	35	40x5	6,0 kg	6,5 kg
96-Z-H	450	350	150	37	40x5	9,6 kg	10,1 kg
120-Z	575	465	110	40	40x5	12,0 kg	12,5 kg
155-Z	630	520	120	40	40x5	15,5 kg	16,1 kg
160-Z-H	550	425	165	40	40x5	16,0 kg	16,8 kg
217-Z	780	680	128	40	40x5	21,7 kg	22,4 kg
260-Z	910	800	120	40	40x5	26,0 kg	26,7 kg
320-Z	1140	1000	120	45	40x5	32,0 kg	33,0 kg
485-Z	1140	1000	120	60	40x5	48,5 kg	49,5 kg
620-Z	1100	1000	120	80	40x5	62,0 kg	63,3 kg